

DAZZLING WEDDINGS

IN THE HEART OF BANGKOK

START FROM THB 50,000

HOTELS DESIGNED TO SAY YES!

radissonblu.com/plazahotel-bangkok/weddings

DAZZLING WEDDINGS

Soft jazz, sophisticated floral arrangements, a seven-tiered wedding cake and flowing champagne. The perfect backdrop tailored to each couple's dreams, the brand new Radisson Blu Plaza Bangkok provides a host of venues for romantic celebrations in the heart of the city.

Set on a private floor with direct access from the lobby and parking lot, the contemporary-chic, pillarless Grand Ballroom can be adapted to accommodate 180-400 guests for dazzling receptions, or 120-280 seated at banquet-style roundtables.

For more intimate receptions, rehearsal dinners or engagement ceremonies, The Suite caters to parties of anywhere between 20-150, with flexible set-ups tailored to the occasion, while open-plan The Gallery with wrap-around views provides a unique cosmopolitan space for cocktail receptions.

Explore the variety of packages we offer, contacting our team of professional planners, and start bringing your dream wedding to life at the Radisson Blu Plaza Bangkok.



ENGAGEMENT & WEDDING CEREMONY

Engagement Ceremony	Engagement 50,000	Chinese Tea Ceremony 55,000	Thai Pouring Ceremony 65,000
Flower Stand	2	2	2
One Golden Flower Tray for rings	○	○	○
Fresh Floral Corsages	4	6	8
A Flower Bouquet	○	○	○
Personalized Backdrop (Foam Cutting)	○	○	○
Sofa Set	X	○	if request
Chinese Tea Set	X	X	○
Thai Pouring Set	X	X	○
One Pair of Wedding Garland	○	○	○
Theater Set Up for Guests	○	○	○
A Night Complimentary Room (Room Only)	Deluxe Room	Deluxe Room	Deluxe Room
Asian OR Western Reception for 50 persons	○	○	○
Additional: Monk Ceremony at baht 15,000 net (included: Buddha Set, Monk Stage with Welcome Tea Set, Thai Set with Water for 9 Monks, 9 Flowers)			

Food & Beverage:

- | | |
|--------------------------------|---|
| • Tea and Coffee | At baht 150 net per person |
| • 3 Snacks with Tea and Coffee | At baht 550 net per person |
| • Dim Sum Lunch | Start from baht 850 net per person |
| • Thai Buffet | Start from baht 1,200 net per person |
| • International Buffet | Start from baht 1,400 net per person |
| • Chinese Set | Start from baht 15,000 net per table (10 persons) |
| • Soft Drink | At baht 250 net per person |

Terms and Conditions:

- 1) Rates are inclusive of 10% service charge and 7% governmental tax
- 2) Rates and packages are subjected to change without prior notice.
- 3) Minimum order at 30 persons is required.

WEDDING RECEPTION

Wedding Package and Benefits	Package 1	Package 2	Package 3
Minimum Spend	350,000	450,000	550,000
Wedding Cake	○	○	○
One Pair of Wedding Garland	○	○	○
Fresh Floral Corsages	4	6	8
Flower Stand	2	2	4
A Flower Bouquet	○	○	○
Wedding Bless Books	2	3	4
Personalized Backdrop (Foam Cutting)	○	○	○
Unlimited Soft Drink and Mixer	○	○	○
Corkage Fee (Whisky and Wine)	○	○	○
A Honeymoon Night Including Breakfast	Deluxe	Junior Suite	Executive Suite
Complimentary Changing Room (Room Only)	1 Deluxe Room	1 Deluxe Room	1 Deluxe Room
Afternoon High Tea in Honeymoon Suite	○	○	○
A Bottle of Beverage	Wine	Sparkling Wine	Champagne
Valet Parking	○	○	○
Pre – Wedding Shooting in Hotel	○	○	○
Anniversary Dinner Voucher at Hotel Restaurant (Food only)	at 2,000 net	at 3,000 net	at 4,000 net

Food & Beverage:

- Cocktail Dinner Start from baht 1,100 net per person
- Thai Buffet Dinner Start from baht 1,200 net per person
- International Buffet Dinner Start from baht 1,400 net per person
- Chinese Set Start from baht 15,000 net per table (10 persons)
- Western Set Start from baht 1,900 net per person
- Soft Drink At baht 250 net per person
- Tea and Coffee At baht 150 net per person

Terms and Conditions:

- 1) Rates are inclusive of 10% service charge and 7% governmental tax.
- 2) Rates and packages are subjected to change without prior notice.



FLOOR PLAN

3RD FLOOR

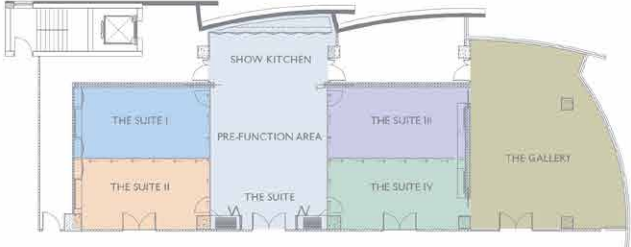

4TH FLOOR

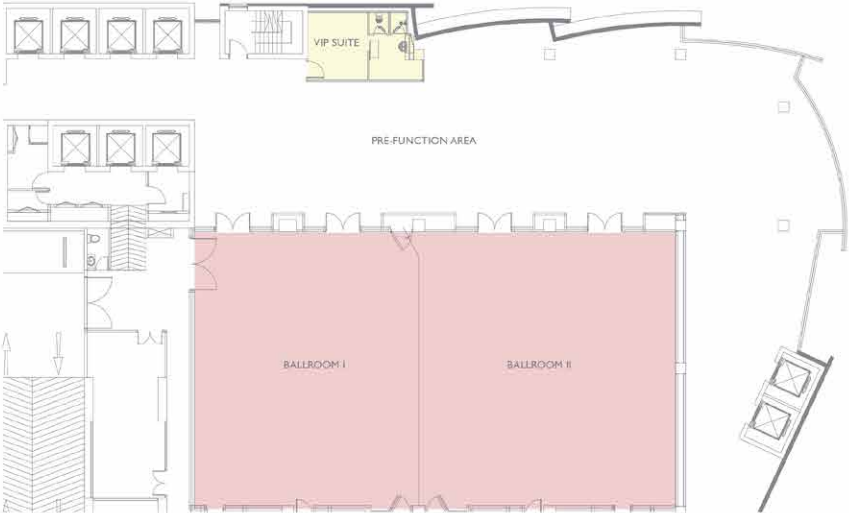

THEMED WEDDINGS AFTER PARTY OPTIONS

ATTICO CUCINA ITALIANA



BREWSKI SPORT BAR



CHINA TABLE



For more information and inspection inquiries
Please contact

023023495

catering.bangkok.blu@radisson.com



GETTING HERE

By car: From Suvarnabhumi Airport take the Srinakarini Expressway at Pattanakarn to the Rama IX Expressway and then Sukhumvit (exiting at North Ploenchit). Turning left onto Sukhumvit Road, pass Asoke junction, keeping left, and continue straight ahead for 200m. The hotel is located just before the entrance to Sukhumvit 27.

By airport rail link: Take any line to Makkasan, and from there transfer to the MRT subway at Petchaburi station. Take the MRT one stop to Asoke – the hotel is a five-minute walk from the station.

RADISSON BLU PLAZA BANGKOK

489 Sukhumvit Road (Soi 27), Klongtoey Nua, Wattana, Bangkok 10110, Thailand

T: +66 2 302 3333 F: +66 2 302 3344

sales.bangkok.blu@radisson.com

radissonblu.com/plazahotel-bangkok