

LEVEL 1 & 4

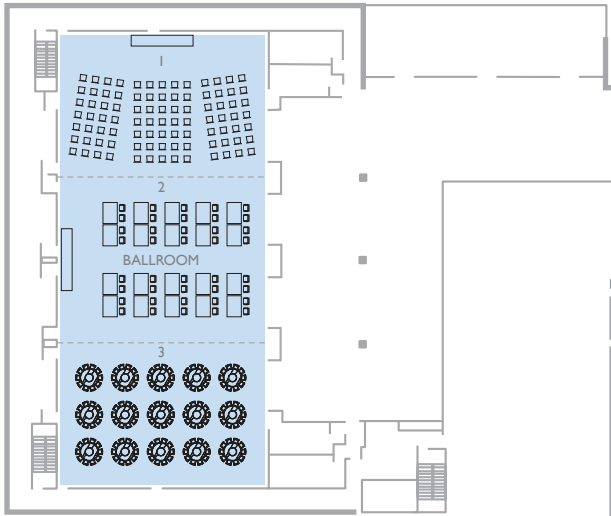

LEVEL 4

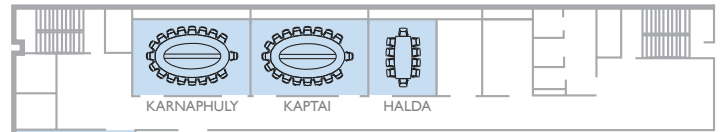

LEVEL 3

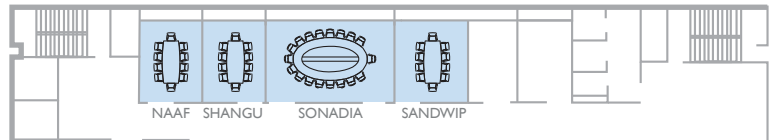

### MEETING ROOM VENUE CAPACITY

RADISSON BLU CHATTOGRAM BAY VIEW	Area (m <sup>2</sup> )	Area (Sq. ft.)	Door height (metres)	Door width (metres)	Length & Width (metres)	Ceiling height (metres)	Natural day light	Cabaret	Hollow Square	Banquet	Classroom	U-Shape	Board Room	Theatre	Cocktail Reception	
Level 1																
Mezban	950	10226	3.2	3.9	43.5 x 20.1	8.6	No	520	200	720	650	165	180	1500	1500	
Mezban 1	315	3390	3.2	3.9	20.1 x 14.5	8.6	No	160	95	220	180	75	85	375	375	
Mezban 2	315	3390	3.2	3.9	20.1 x 14.5	8.6	No	160	95	220	180	75	85	375	375	
Mezban 3	315	3390	3.2	3.9	20.1 x 14.5	8.6	No	160	95	220	180	75	85	375	375	
Mezban Pre-function area	275	-	-	-	-	-	-	-	-	-	-	-	-	-	-	
Level 2																
Business Centre Meeting Room 1	48	517	2.8	0.93	8.5 x 5.6	2.92	Yes	-	-	-	-	-	10	-	-	
Business Centre Meeting Room 2	18	190	2.9	0.93	4.40 x 4.25	2.92	Yes	-	-	-	-	-	6	-	-	
Level 3																
Nilachol	70	753.47	2.65	1.23	8.8 x 8.3	2.7	Yes	-	-	-	-	-	18	-	-	
Potenga	70	753.47	2.1	0.91	8.6 x 8	2.7	Yes	-	-	-	-	-	18	-	-	
Naaf	25	269.1	2.1	0.91	5.9 x 3.8	3	No	-	-	-	-	6	8	-	-	
Sandwip	38	409.03	2.1	0.91	6.3 x 6	3	No	-	-	-	-	6	8	-	-	
Sonadia	55	592.02	2.1	0.91	8.3 x 6.3	3	No	-	-	-	-	16	18	-	-	
Shangu	22	236.81	2.1	0.91	5.8 x 3.7	3	No	-	-	-	-	6	8	-	-	
Level 4																
Mohona	950	10226	3.2	3.9	43.5 x 20.1	5.12	No	520	200	720	650	165	180	1500	1500	
Mohona 1	315	3390	3.2	3.9	20.1 x 14.5	5.12	No	160	95	220	180	75	85	375	375	
Mohona 2	315	3390	3.2	3.9	20.1 x 14.5	5.12	No	160	95	220	180	75	85	375	375	
Mohona 3	315	3390	3.2	3.9	20.1 x 14.5	5.12	No	160	95	220	180	75	85	375	375	
Mohona Pre-function area	175	-	-	-	-	-	-	-	-	-	-	-	-	-	-	
Bride Lounge	39	419.79	1.8	2.1	7.4 x 5.3	2.9	Yes	-	-	-	-	-	-	-	-	
Groom Lounge	42	452.08	1.8	2.1	7.9 x 5.3	2.9	Yes	-	-	-	-	-	-	-	-	
Common Lounge	40	430.56	1.8	2.1	7.6 x 5.3	2.9	Yes	-	-	-	-	-	-	-	-	
Meghla	112	1210	2.9	0.91	13 x 8.5	2.9	Yes	30	25	40	40	16	18	60	60	
St. Martin	70	753.47	2.1	0.91	8.6 x 8	2.7	Yes	-	-	-	-	18	20	-	-	
Karnaphuly	53	570.49	2.1	0.91	8.3 x 6.3	3	No	-	-	-	-	16	18	-	-	
Kaptai	53	570.49	2.1	0.91	8.3 x 8	3	No	-	-	-	-	16	18	-	-	
Halda	22	236.81	2.1	0.91	5.8 x 3.7	3	No	-	-	-	-	6	8	-	-	
Level 5																
Nilgiri	168	1816	2.7	1.8	23 x 6.4	2.7	Yes	50	40	80	60	40	50	120	100	