



MEETINGS AND EVENTS

WELCOME

THE RADISSON BLU EDWARDIAN, NEW PROVIDENCE WHARF GIVES YOU SEVEN HIGH-SPEC MEETING AND EVENT SPACES IN A SERENE WATERSIDE LOCATION MOMENTS FROM CANARY WHARF.

With tomorrow's technology, seamless service, and a great bar and restaurant for time out on the river, this is a place designed for relaxation and clear thinking.



 Free high-speed Wi-Fi up to 150mbps on an unlimited number of devices

 Edward, our virtual concierge is available to guests and meeting organisers 24/7



FOOD FOR THOUGHT

DISCOVER WORLD-CLASS DINING IN AN ICONIC LOCATION

Our food and drink teams are here to ensure you stay energised, motivated and focused, with a range of delicious menus to choose from. We promise to go above and beyond to bring you the very best in innovative and responsible gastronomy.

Specifically designed to improve efficiency and your ability to concentrate, we have a fantastic range of simple, wholesome and tasty offerings. Menus can be tailored to your tastes, and our expert teams - dedicated and discreet, can set the scene to match the mood.

EDWARD FOR MEETINGS

MEET EDWARD:
YOUR DEDICATED
CONFERENCE HOST

Edward is an innovative and unique chatbot, developed specifically to match the needs of the hospitality industry. He responds to guests' requests via SMS text messaging. Edward is available to all residential guests and organisers at the hotel.



CAPACITIES



	Theatre	Classroom	Boardroom	U-shape	Cabaret	Reception	Lunch/Dinner
Ontario Room	250	130	60	50	120	250	180
Ontario Room A	120	70	30	36	60	125	70
Ontario Room B	100	70	40	36	60	125	70
Ontario Foyer/bar	-	-	-	-	-	70	-
River Room	70	25	22	15	24	70	50
Private Room 1	50	18	18	14	15	30	30
Private Room 2	50	18	18	12	15	30	30
Private Room 1&2	100	36	26	27	40	100	60
Private Room 3	-	-	13	-	-	-	15
Private Room 4	-	-	8	-	-	-	8
Private Room 5	30	-	15	15	-	-	20

FLOOR DIMENSIONS

	Area	Length m (ft)	Width m (ft)	Height m (ft)
Ontario Room	210 m ² (222.3 ft ²)	17.5 m (57')	12 m (39')	3.5 m (11'6")
Ontario Room A	103 m ² (109.2 ft ²)	8.6 m (28')	12 m (39')	3.5 m (11'6")
Ontario Room B	104 m ² (109.2 ft ²)	8.7 m (28')	12 m (39')	3.5 m (11'6")
Ontario Foyer/bar	116 m ² (123.5 ft ²)	29 m (95')	4 m (13')	3.1 m (10')
River Room	72 m ² (775 ft ²)	11 m (36')	6 m (20')	3.1 m (10')
Private Room 1	40 m ² (42.0 ft ²)	6.2 m (20')	6.5 m (21')	3.1 m (10')
Private Room 2	41 m ² (44.0 ft ²)	6.7 m (22')	6.1 m (20')	3.1 m (10')
Private Room 1&2	81 m ² (86.0 ft ²)	12.9 m (42')	6.5 m (21')	3.1 m (10')
Private Room 3	32 m ² (338 ft ²)	8 m (26')	4 m (13')	2.3 m (7'6")
Private Room 4	24 m ² (258 ft ²)	6.2 m (20')	3.8 m (12')	2.7 m (8'10")
Private Room 5	36 m ² (399 ft ²)	6.4 m (21')	5.7 m (19')	2.7 m (8'10")





GROUND FLOOR

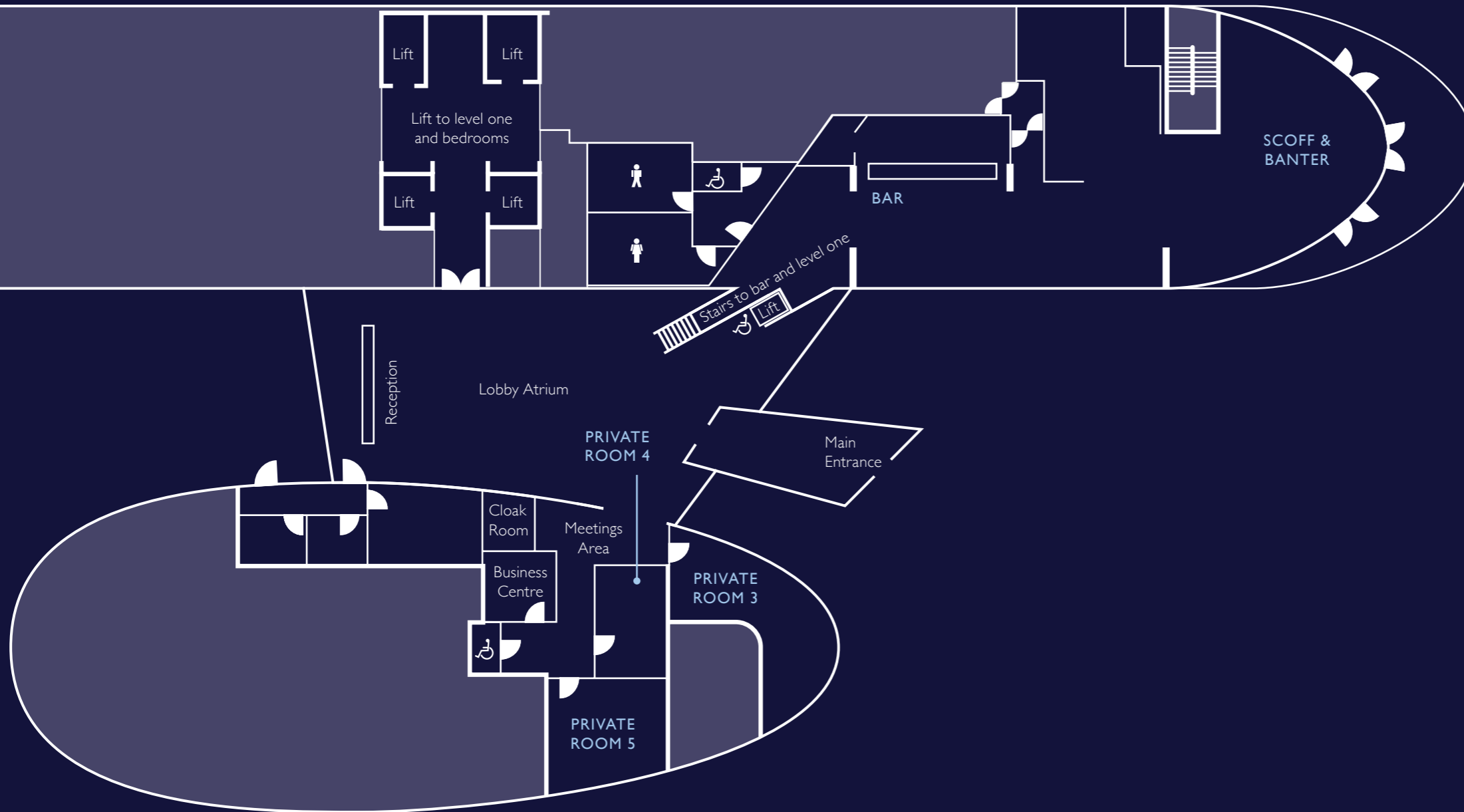

ALL MEETING ROOMS ARE FULLY AIR CONDITIONED AND BENEFIT FROM:

- Free, fast Wi-Fi up to 150mbps
- Dedicated audio-visual support
- LCD projection screens
- Business centre with printing facilities
- Audio visual equipment, bespoke staging and additional lighting on request



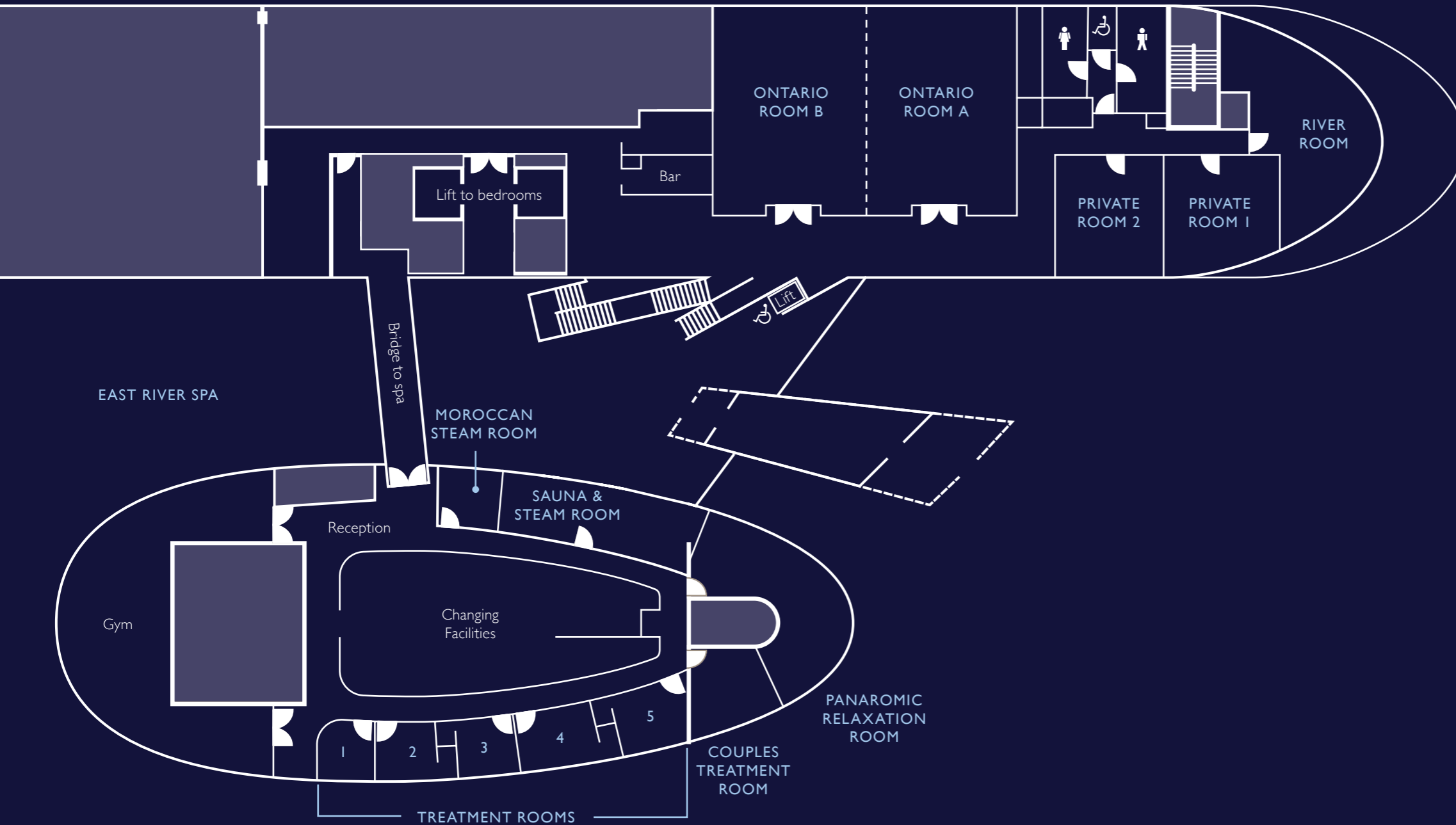

FIRST FLOOR

ALL MEETING ROOMS ARE FULLY AIR CONDITIONED AND BENEFIT FROM:

- Free, fast Wi-Fi up to 150mbps
- Dedicated audio-visual support
- LCD projection screens
- Business centre with printing facilities
- Audio visual equipment, bespoke staging and additional lighting on request

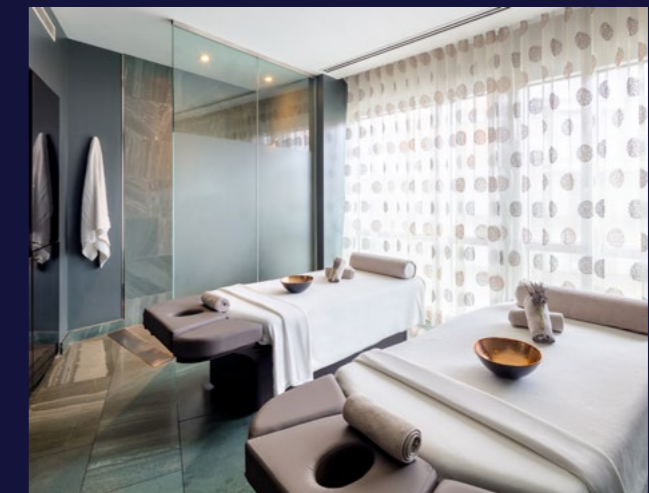

LOCATION

Ideally located close to the Excel Exhibition Centre, O2 Arena, Canary Wharf and City Airport, the hotel is also just moments from East India DLR station.

NEW PROVIDENCE WHARF

★★★★ (deluxe)

5 Fairmont Avenue
London
E14 9PJ

T +44 (0)20 7987 6566
F +44 (0)20 7987 8424
E npwcb@radisson.com

TRAVEL

Car Park

Onsite valet parking is available

Underground

Canary Wharf/Canning Town
(Jubilee Line)

East India/Blackwall (DLR)

Train

King's Cross St. Pancras
Eurostar (7 miles)

Airport

City Airport (3.4 miles)
Heathrow (22 miles)
Gatwick (33 miles)
Stansted (35 miles)
Luton (40 miles)

Shuttle Service

Complimentary shuttle to
Canary Wharf operates:
Monday to Friday 6:45am - 9:30am

There is an additional Friday
service between 4:30pm - 6:30pm
Saturday to Sunday 10am - 12pm
and 4:30pm - 6:30pm

A return service operates from
Canary Wharf back to the hotel
Monday to Friday.

Please ask concierge for details.

POINTS OF INTEREST

- 1 Blackwall Station (9 mins walk)
- 2 Billingsgate Fish Market (12 mins walk)
- 3 East India Station (9 mins walk)
- 4 Canary Wharf Station (18 mins walk)
- 5 Trinity Buoy Wharf (20 mins walk)
- 6 Museum Of London Docklands (21 mins walk)
- 7 Mudchute Farm and Park (8 mins by car)
- 8 The O2 Arena (10 mins by car)
- 9 Excel London (10 mins by car)
- 10 London City Airport (12 mins by car)
- 11 Bromley-by-Bow (13 mins by car)
- 12 Emirate Cable Cars (14 mins by car)
- 13 Greenwich Market (16 mins by car)
- 14 National Maritime Museum and Gardens (16 mins by car)

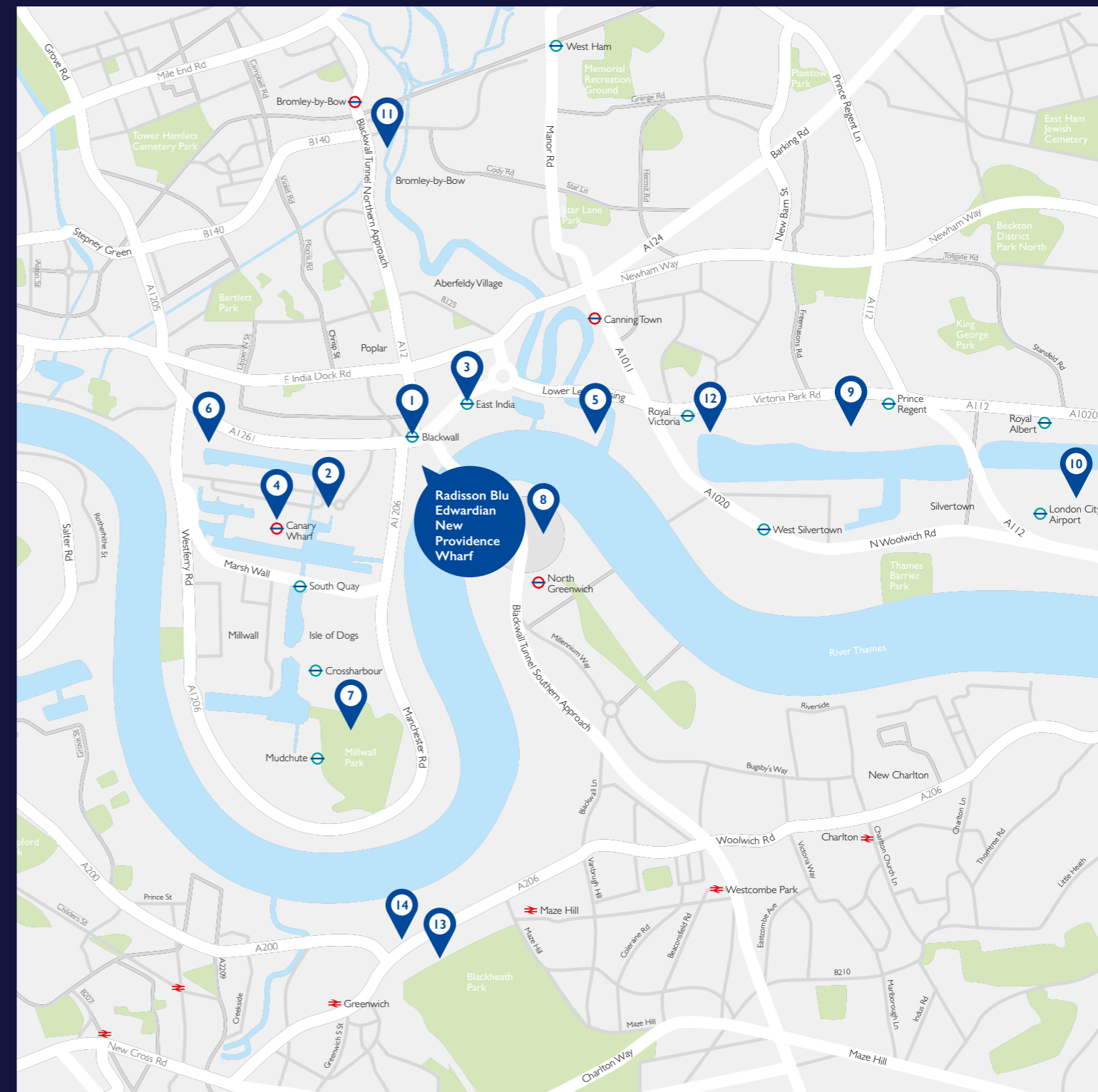



RADISSON BLU EDWARDIAN,
NEW PROVIDENCE WHARF

★★★★ (deluxe)

5 Fairmont Avenue
Canary Wharf
London E14 9JB

T +44 (0)20 7987 6566

F +44 (0)20 7987 8424

E npwcb@radisson.com

W radissonblu-edwardian.com/newprovidencewharf

Owned and managed by Edwardian Hotels London