



**PARKPLAZA**

LONDON RIVERBANK

*Personal  
Professional  
Memorable*

# Outstanding Central London Conference Centre

SLEEP, EAT AND MEET IN OUR AWARD-WINNING CONFERENCE VENUE AND HOTEL



**3**

ACCESS TO VAUXHALL, WATERLOO AND WESTMINSTER STATIONS

**40 min**

TO LONDON CITY AIRPORT

**45 min**

TO HEATHROW AIRPORT



**24**

FLEXIBLE MEETING ROOMS

**1,700 m<sup>2</sup>**

MEETING SPACE

**660**

GUEST CAPACITY

**1**

CAR LIFT DIRECTLY TO BALLROOM



PRIVATE GROUP CHECK-IN



HYBRID MEETINGS



FULL AV CAPABILITIES



DEDICATED EVENT ENTRANCE



**645**

GUEST ROOMS

**1**

RESTAURANT & BAR

**1**

EXECUTIVE LOUNGE

**1**

OUTDOOR TERRACE



# Floor Plans

## Mezzanine Level

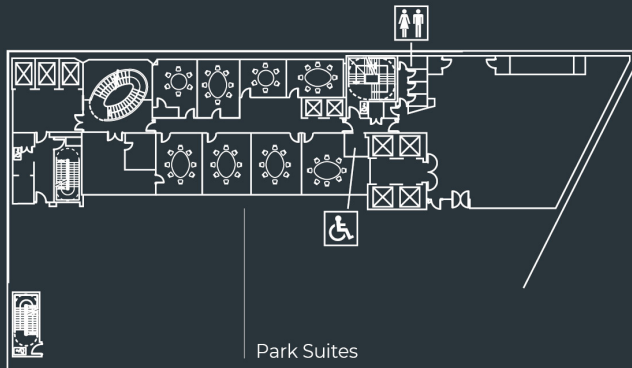

## Conference Level -1

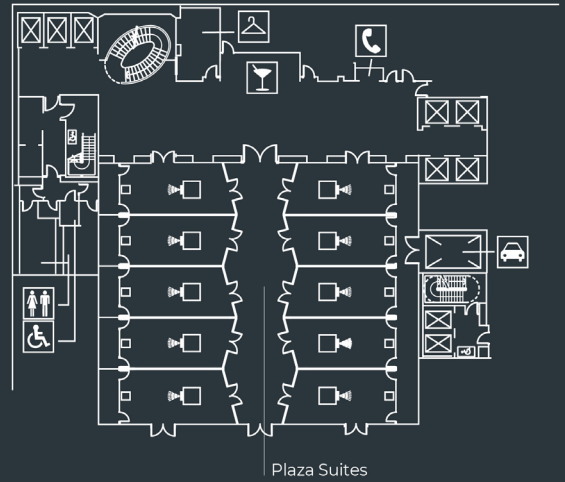

## Conference Level -2

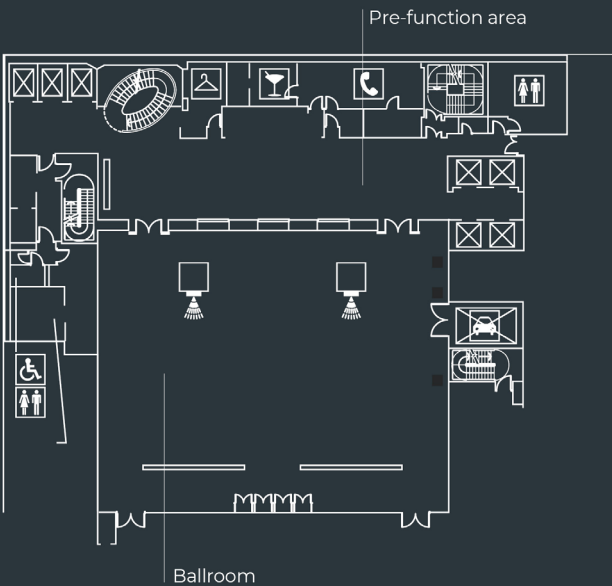

# Capacities

ROOM NAME	DIMENSION W X L X H	SIZE (M <sup>2</sup> )	THEATRE	BOARD- ROOM	U- SHAPE	CLASS ROOM	CABARET	DINNER	DINNER DANCE	RECEP- TION
<b>BALLROOM</b>										
Ballroom 1+2	22.9 x 27.9 x 5	638.9	650			450	432	540	490	660
Ballroom 1	22.9 x 13.9 x 5	318.3	300		54	216	200	250	200	450
Ballroom 2	22.9 x 13.9 x 5	318.3	300		54	216	216	250	200	450
<b>CONFERENCE LEVEL -4</b>										
The Plaza Suite	24.5 x 22.8 x 2.3	558.60	550			330	304	400	340	550
Single Plaza Room	9.5 x 4.5 x 3.95	42.7	40	22		24	32	30		40
Double Plaza Room	9.5 x 9 x 3.95	85.5	80	32	23	48	56	60		80
Triple Plaza Room	9.5 x 13.5 x 3.95	128.3	120	40	30	60	88	90	60	120
Quadruple Plaza Room	9.5 x 18 x 3.95	171	160			72	110	120	90	160
Half the Plaza Suite	9.5 x 22.5 x 3.95	213.7	200			84	140	180	150	200
<b>MEZZANINE LEVEL - PARK SUITES &amp; BUSINESS CENTRE</b>										
Plaza Suite 1	5.8 x 4.3 x 2.3	24.9	15	10				10		
Plaza Suite 2	5.1 x 4.9 x 2.3	25	20	14				14		
Plaza Suite 3	5.8 x 4.3 x 2.3	24.9	15	10				10		
Plaza Suite 4	6.0 x 4.8 x 2.3	28.8	24	14				14		
Plaza Suite 5	5.9 x 3.6 x 2.3	21.2	18	10				10		
Plaza Suite 6	4.3 x 3.6 x 2.3	15.5		10				10		
Plaza Suite 7	5.4 x 3.9 x 2.3	21	12	10				10		
Plaza Suite 8	4.0 x 3.9 x 2.3	15.6	10	6				6		
<b>GROUND FLOOR - CITY SUITES</b>										
City Suite	12.5 x 24.5 x 3.1	360.3	380			135	200	250	264	400
City Suite 1	12.5 x 12.2 x 3.1	152.5	120		45	75	96	120	120	120
City Suite 2	12.5 x 6.2 x 3.1	76.3	60		27	30	48	60		60
City Suite 3	12.5 x 6.2 x 3.1	77.5	60		27	30	48	60		60
City Suite 1+2	12.5 x 18.3 x 3.1	228.8	180		54	105	144	150	120	180
City Suite 2+3	12.5 x 12.3 x 3.1	153.8	150		45	60	96	120	100	150

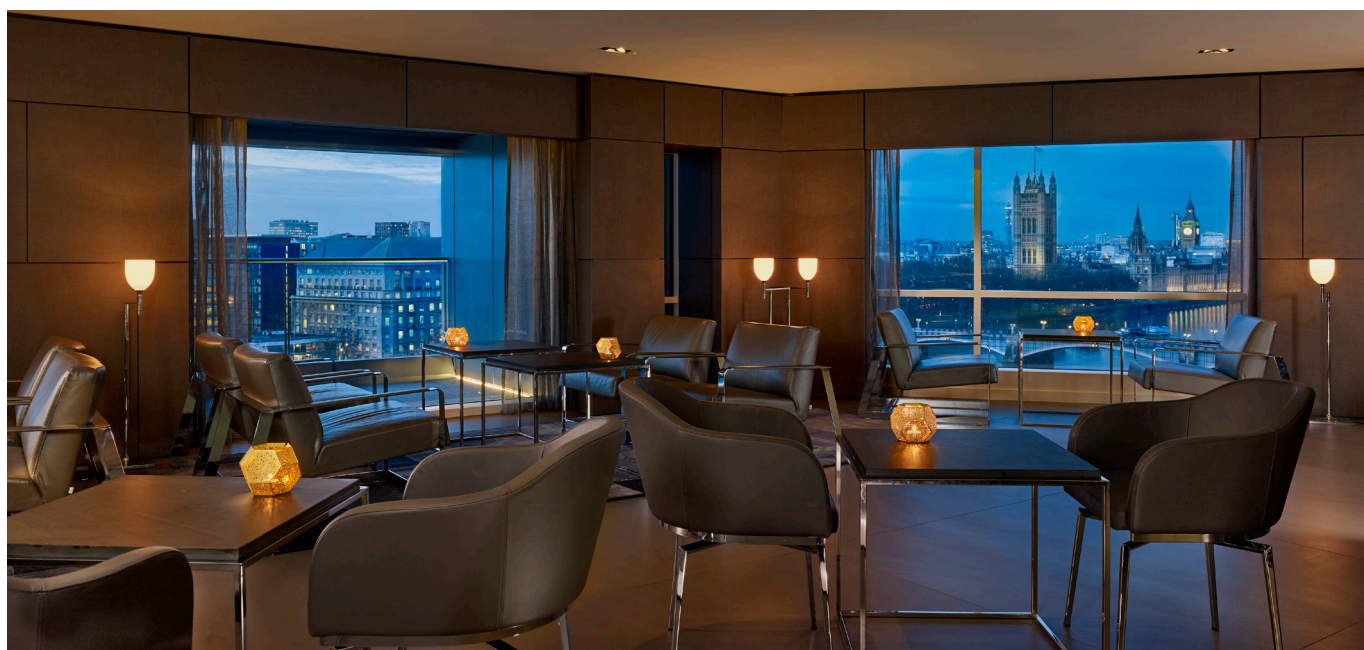



SPACIOUS MEETINGS



STYLISH FACILITIES



HEALTH & FITNESS FACILITIES



OUTSTANDING LOCATION



645 GUEST ROOMS



AWARD-WINNING DINNERS

**NEED A QUOTE?**

Our experienced sales team would be delighted to send you a customised proposal. Please contact us on: [reassuringmeetings@pphe.com](mailto:reassuringmeetings@pphe.com) or +44 (0) 333 400 6102 [parkplaza.com](http://parkplaza.com)