



PARK PLAZA

LONDON PARK ROYAL

---

*Meetings & Events,  
Expertly Delivered*

---

# *A flexible meeting and event hotel in West London for up to 96 delegates*

WE OFFER A WELL-CONNECTED VENUE THAT FEATURES  
4 CONTEMPORARY MEETING FACILITIES WITH NATURAL DAYLIGHT



**40 min**

TO HEATHROW  
AIRPORT

**45 min**

TO KINGS CROSS  
AND ST PANCRAS

**Sightseeing**

WEMBLEY STADIUM,  
OVO ARENA, WESTFIELD  
SHOPPING CENTRE



**4**

FLEXIBLE  
MEETING ROOMS

**84 m<sup>2</sup>**

MEETING  
SPACE

**96**

GUEST  
CAPACITY



**PRIVATE GROUP  
CHECK-IN**



**CARBON NEUTRAL  
MEETINGS**



**FULL  
AV CAPABILITIES**



**212**

GUEST  
ROOMS

**1**

RESTAURANT  
& BAR

**1**

OUTSIDE  
TERRACE



# Floor Plan

## Ground Floor

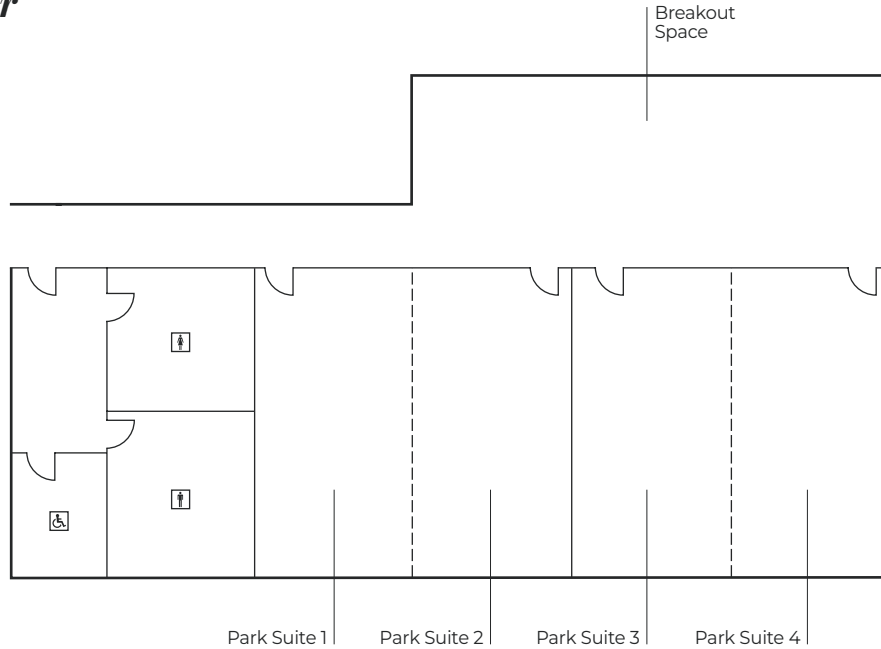

Park Plaza London Park Royal is a modern, airy meeting and event hotel in the heart of the West End. Each of the four meeting rooms can be hired separately for team away days or combined as one to host your next big get-together. Nearby, we're well-connected to central London, Wembley, Heathrow Airport, and the M25, as well as being just a two-minute walk from the Underground. We also have an on-site restaurant and bar available, plus group dining, along with parking for 40 vehicles and coach drop-off. Staying over? We have interconnecting and twin rooms available, plus free added extras like early check-in and late check-out.

# Capacities

ROOM NAME	DIMENSION WXLXH	SIZE M <sup>2</sup>	THEATRE	BOARD ROOM	U SHAPE	CLASS ROOM	CABARET (8)	DINNER	RECEPTION
<b>GROUND FLOOR</b>									
Park Suite 1	3.5x6.1x3.1	21.10	20	12					
Park Suite 2	3.5x6.1x3.1	21.10	20	12					
Park Suite 3	3.5x6.1x3.1	21.10	20	12					
Park Suite 4	3.5x6.1x3.1	21.10	20	12					
Park Suite 1 & 2	6.9x6.1x3.1	42.20	48	16	15	24	20	40	55
Park Suite 3 & 4	6.9x6.1x3.1	42.20	48	16	15	24	20	40	55



CONTEMPORARY DINING



FLEXIBLE MEETING ROOMS



212 GUEST ROOMS



STYLISH FACILITIES

**NEED A QUOTE?**

Our experienced sales team would be delighted to send you a customised proposal. Please contact us on: [ppprconf@pphe.com](mailto:ppprconf@pphe.com) or +44 (0) 203 146 5616 [parkplaza.com](http://parkplaza.com)